



CHRISTENSEN
REAL ESTATE GROUP



SUB-PENTHOUSE 705 | TORONTO

430 Roncesvalles Avenue



Welcome Home



FOR MORE
PHOTOS + DETAILS

Magnificent south-facing suite with a rare 20' balcony. Glorious lake and city views from sunrise to sunset. Sun-filled two bedroom & den, sub-penthouse in The Roncy, an eco-friendly boutique, low rise condominium, in the heart of historic Roncesvalles Village.

Live without compromise in this highly functional suite. Relax on the expansive balcony. Rare outdoor area perfect for entertaining, watching the air show or bbq your favourite meal. Stunning open concept living area with well equipped chefs kitchen & centre island.

2+1 BEDROOM | 2 BATHROOM | SOUTH FACING | SUB-PENTHOUSE

Primary bedroom has floor to ceiling windows with custom blackout blinds, his and her closets and a spa-like ensuite bath. Versatile second bedroom with sliding glass entryway and large mirrored closet can also function as an at-home office. Convenient open concept den. Large four-piece bathroom. Designer decor and finishes. Luxury upgrades including a centre island, custom blinds and built-ins.

Deeded parking space and convenient storage locker. Amenities include party room, outdoor fireplace, fitness centre, pet wash and bike storage area.

Ideally located, surrounded by storied High Park with an abundance of restaurants, boutiques, grocers, and transit at your doorstep.



ENTRYWAY

- Large LED pot light fixture
- Coat closet with storage
- Modern baseboard
- Laminate floor

KITCHEN

- Matte black ceiling track light fixture
- Abundance of soft close flat panelled white lacquer cabinets and drawers
- Ceramic tile backsplash
- Quartz countertop, under-mount stainless steel sink with brushed chrome widespread faucet and pull down sprayer
- Stainless steel KitchenAid built-in dishwasher
- Stainless steel Whirlpool four-burner gas stove
- Stainless steel Whirlpool refrigerator with under-mount freezer
- Upgraded kitchen island with two person seating, flat panelled white lacquer soft close pot drawers and overhead matte black pendant light fixture
- Laminate floor

DEN

- Large LED pot light fixture
- Modern baseboard
- Laminate floor

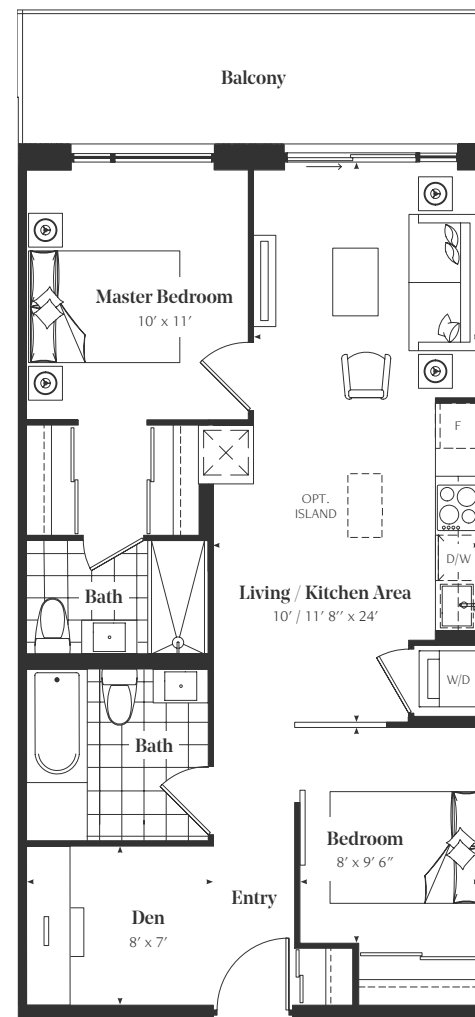

LIVING ROOM/DINING ROOM

- Wall to wall walk out to a 20 foot south facing balcony
- Custom privacy blinds
- Modern baseboard
- Laminate floor

LAUNDRY CLOSET

- Stacked Whirlpool washer and dryer
- Tile floor

FOUR-PIECE BATHROOM

- LED pot lights
- Vanity mirror
- Quartz countertop with under-mount sink, brushed chrome finished faucet and flat panelled white lacquer soft close cabinets and drawers
- Built-in shelving
- Soaker tub with ceramic tile surround and rain shower head
- Eco friendly toilet
- Porcelain tile baseboard
- Porcelain tile floor

INCLUDES

- One deeded parking space and locker
- High Speed internet



PRIMARY BEDROOM

- Wall to wall, floor to ceiling south facing windows with casement
- Custom blackout blinds
- His and her large sliding door closets and overhead large LED pot light fixture
- Modern baseboard
- Laminate floor

THREE-PIECE ENSUITE

- LED pot lights
- Vanity mirror
- Quartz countertop with under-mount sink, brushed chrome finished faucet and flat panelled white lacquer soft close cabinets and drawers
- Frameless tempered glass enclosed walk-in shower with ceramic tile surround and floor and rain shower head
- Eco friendly toilet
- Porcelain tile baseboard
- Porcelain tile floor



SECOND BEDROOM

- Tempered glass sliding glass door entryway
- Mirrored closet with storage
- Modern baseboard
- Laminate floor





CHRISTENSEN
REAL ESTATE GROUP



Ready to Reach Out?

Christensen Real Estate Group
christensengroup.ca

Evan Christensen Broker 416-722-4723
Niels Christensen Broker 416-315-4480



Harvey Kalles Real Estate Ltd., Brokerage
2316 Bloor Street West, Toronto, ON M6S 1P2
This is not intended to solicit buyers or sellers currently under contract.

